

Reveal Base

PRODUCT DETAIL : Full Scale

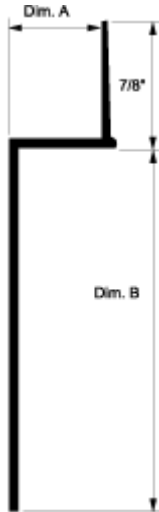

USAGE

Fry Reglet Reveal Base is used at bottom of wall to form an attractive, damage-resistant recessed base.

GUIDE SPECIFICATION

Where indicated on drawings, Fry Reglet Reveal Base, as manufactured by Fry Reglet Corporation, shall be installed. Aluminum shall be extruded alloy 6063 T5, with chemical conversion coating, unless otherwise specified.

INSTALLATION DETAIL : Cross Section

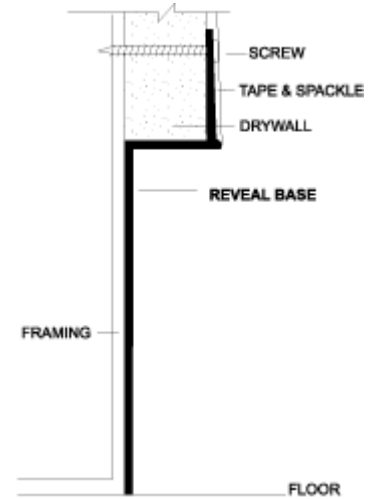

INSTALLATION DETAIL : Perspective

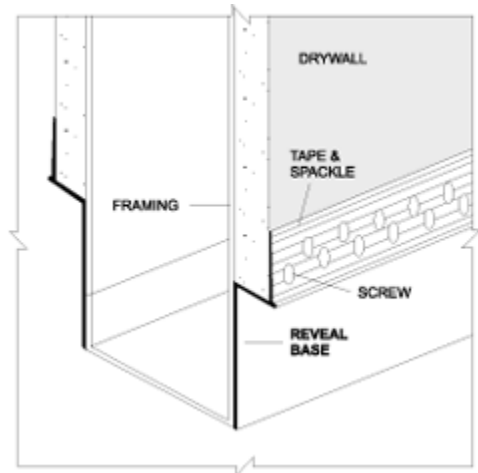

REVEAL BASE SIZES

DIM. A REVEAL DEPTH	DIM. B REVEAL WIDTH	NUMBER
1/2"	4"	DRMB-50-400
5/8"	2 1/2"	DRMB-625-250
5/8"	3"	DRMB-625-300
5/8"	4"	DRMB-625-400
5/8"	6"	DRMB-625-600