

PRODUCT DETAIL :

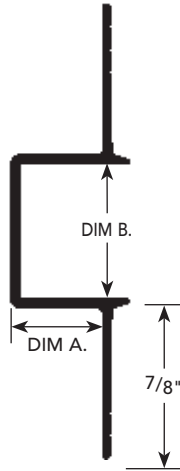

USAGE

Fry Reglet Veneer Plaster Reveal Molding creates an attractive vertical or horizontal recessed reveal in veneer plaster. Reveals can become a design element to enhance building interiors. Reveal widths from $\frac{3}{8}$ " to $\frac{3}{4}$ " for choice of design effects.

GUIDE SPECIFICATION

Where indicated on drawings, Fry Reglet Veneer Plaster Reveal Molding, as manufactured by Fry Reglet Corporation, shall be installed. Aluminum shall be extruded alloy 6063 T5, with chemical conversion coating, clear anodized or othe specified finish. Refer to finish section.

INSTALLATION DETAIL : Cross Section

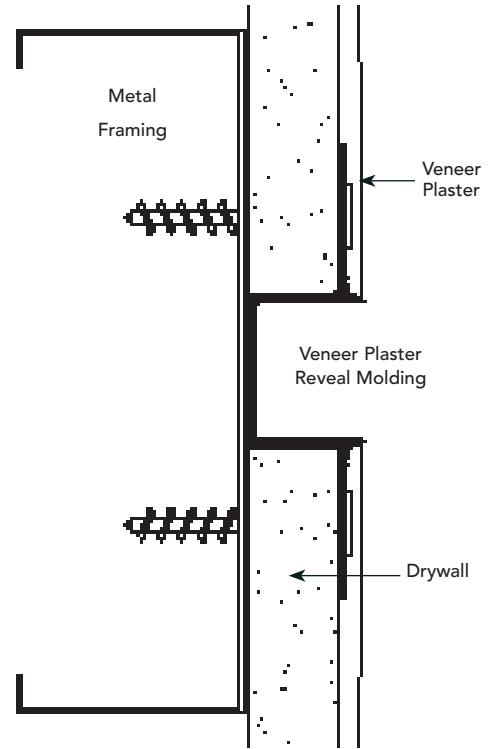

VENEER PLASTER REVEAL MOLDING SIZES

DIM. A REVEAL DEPTH	DIM. B REVEAL WIDTH	PRODUCT NUMBER
$\frac{3}{8}$ "	$\frac{3}{8}$ "	VPR-375-375
$\frac{1}{2}$ "	$\frac{1}{2}$ "	VPR-50-50
$\frac{1}{2}$ "	$\frac{3}{4}$ "	VPR-50-75
$\frac{1}{2}$ "	$1\frac{1}{2}$ "	VPR-50-150
$\frac{5}{8}$ "	$\frac{3}{8}$ "	VPR-625-375
$\frac{5}{8}$ "	$\frac{1}{2}$ "	VPR-625-50
$\frac{5}{8}$ "	$\frac{5}{8}$ "	VPR-625-625
$\frac{5}{8}$ "	$\frac{3}{4}$ "	VPR-625-75