

PRODUCT DETAIL :

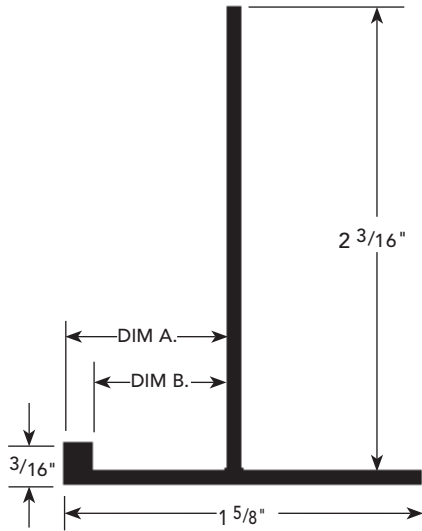

INSTALLATION DETAIL : Cross Section

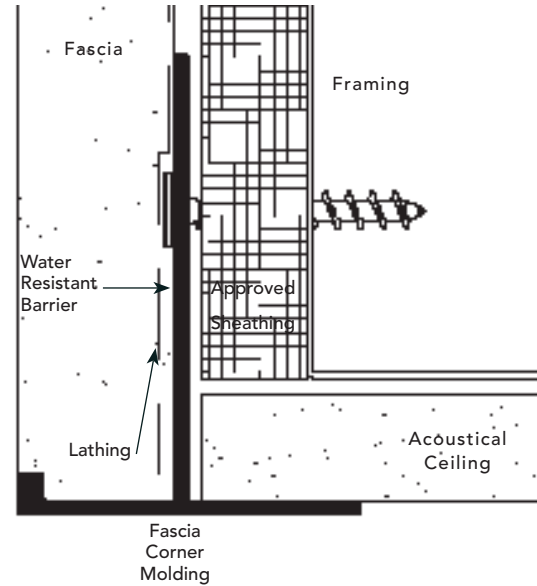

USAGE

Fry Reglet Fascia Corner Molding can be applied to fascia corner where an acoustical ceiling joins the vertical surface of plaster, stucco or drywall/veneer plaster systems.

GUIDE SPECIFICATION

Where indicated on drawings, Fry Reglet Fascia Corner Molding, as manufactured by Fry Reglet Corporation, shall be installed. Aluminum shall be extruded alloy 6063 T5, with chemical conversion coating, clear anodized or other specified finish. Refer to finish section.

FASCIA CORNER MOLDING SIZES

FACE WIDTH	DIM. A	DIM. B	NUMBER	APPLICATION
1 5/8"	5/8"	1/2"	FCM-50	DRYWALL
1 5/8"	3/4"	5/8"	FCM-625	DRYWALL
1 5/8"	3/4"	5/8"	FCM-75	PLASTER