

PRODUCT DETAIL :

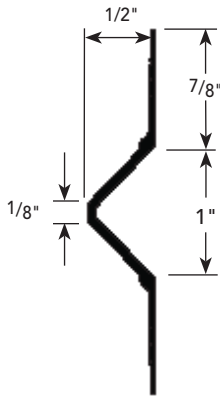

INSTALLATION DETAIL : Cross Section

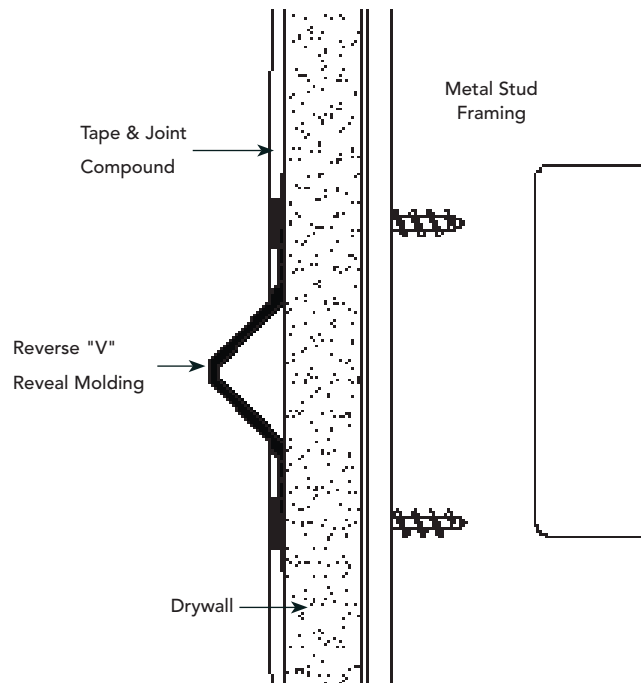

USAGE

Fry Reglet Reverse "V" Reveal Molding protrudes from wall surface for a raised dimensional effect. Reverse "V" Reveal Molding can also be used as a chair rail and to protect wall surface.

GUIDE SPECIFICATION

Where indicated on drawings, Fry Reglet Reverse "V" Reveal Molding, as manufactured by Fry Reglet Corporation, shall be installed. Aluminum shall be extruded alloy 6063 T5, with chemical conversion coating, clear anodized or other specified finish. Refer to finish section.

REVERSE "V" REVEAL MOLDING SIZES

REVEAL WIDTH	NUMBER
1"	DRMVR-100

INSTALLATION DETAIL : ISO View

