

Reverse "V" Reveal Molding

PRODUCT DETAIL : Full Scale

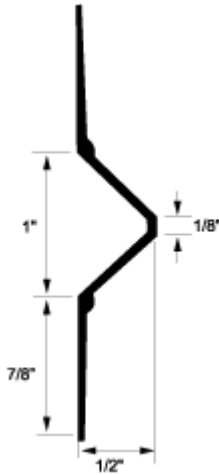

USAGE

Fry Reglet Reverse "V" Reveal Molding protrudes from wall surface for a raised dimensional effect. Reverse "V" Reveal Molding can also be used as a chair rail and to protect wall surface.

GUIDE SPECIFICATION

Where indicated on drawings, Fry Reglet Reverse "V" Reveal Molding, as manufactured by Fry Reglet Corporation, shall be installed. Aluminum shall be extruded alloy 6063 T5, with chemical conversion coating, unless otherwise specified.

INSTALLATION DETAIL : Cross Section

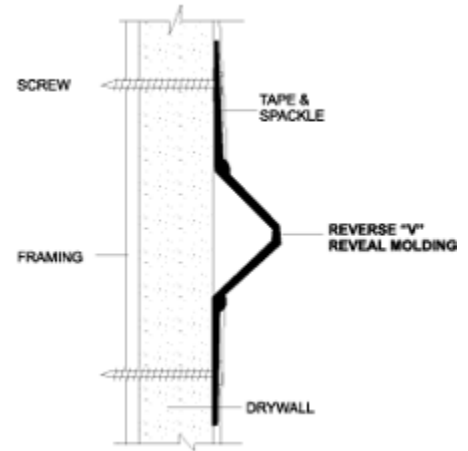

INSTALLATION DETAIL : Perspective

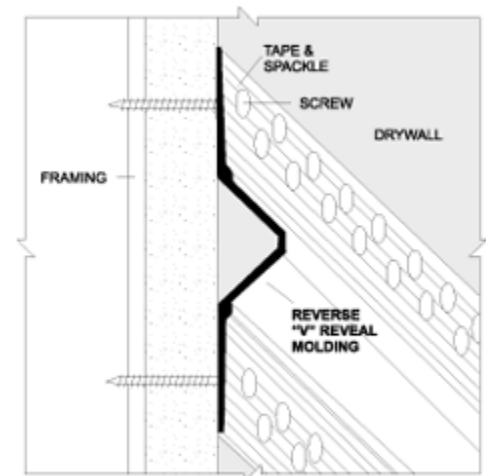

REVERSE "V" REVEAL MOLDING SIZE

REVEAL WIDTH	NUMBER
1"	DRMVR-100